



Ron 2000 Shackle Type Dynamometer with Remote Indicator

Short delivery time:

Usually 2 - 4 business days.

High quality Aerospace Steel

for increased strength and safety.

Exceptionally small dimensions

enable minimum headroom loss and portability. For example: Height of the 12.5t load cell is 5.2 inch / 131 mm
 Weight: 3.1 lbs / 1.4kg

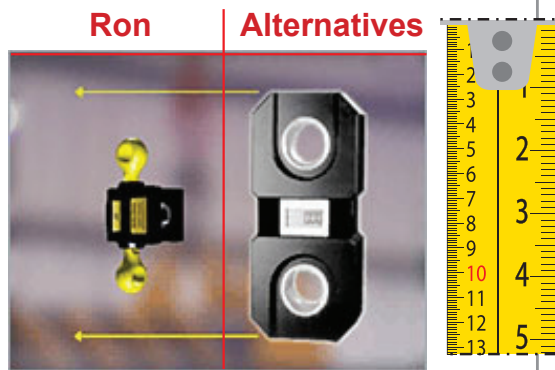

Unique design: 90° between shackle holes eliminates external moments and consequently increases accuracy, safety and longevity.

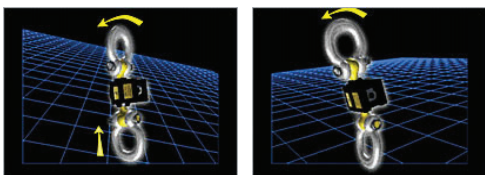

New: Fatigue rated load cells - an important and unique safety feature: All Ron crane scales and dynamometers are now Fatigue Rated. They have an improved fatigue resistance level.

Advanced options such as: Integrated data logger, analog output, averaging / dampening and more

More than three decades in the market:

Eilon Engineering Ltd. has specialized in the development and manufacturing of Ron crane scales and dynamometers since 1976. We have thousands of repeat customers such as NASA, Boeing, US Air Force and many more.

Standard remote display

enables the user to conveniently read the measured values from a safe distance.

Exceptionally long battery life:

Up to 2000 hours on AA disposable batteries with battery life indication.

Optional wireless communication

to additional display or PC that allows for multiple Ron crane scales / dynamometers in one area to send measurements to a centralized location.

Wide temperature range:

Load cell: -15°F to +175°F
 (-25°C to +80°C)
 Indicator: -4°F to +158°F
 (-20°C to +70°C).

Double overload warning is displayed on the screen at 100% of full scale and at 130%.

Optional offshore and under-water load cell sealing levels:

High sealing levels IP 67 and IP 68 for offshore and underwater applications.



Shackles not included





Ron 2000 Shackle Type Dynamometer with Remote Indicator

Description

Ron 2000 Shackle Type is a small, lightweight and portable Dynamometer. It is therefore especially suitable for applications that require portability and minimum headroom loss (for example indoors applications).

Ron 2000's long battery life (up to 2000 hours) is also an important feature for working long periods on site.

Ron 2000 is a basic, easy-to-operate and very reliable dynamometer. It was first launched in 1988 and since then many thousands of Ron 2000 dynamometers have been sold worldwide. The load cell's unique perpendicular hole structure neutralizes external moments and thus improves safety and accuracy.

The optional additional wireless display enables transmission of the measured values to a remote location.

Dynamometers are used for weighing during lifting, force measurement (bollard pull tests), tension measurement (the dynamometer then serves as a tension load meter, used for cable tension measurement, etc.), load measuring and load control.

Ron 2000's indicator is separated from the load cell and is held by the user. This separation ensures the user's safety since under no circumstances will they have to approach the load in order to read the result. This separation also guarantees the dynamometers' durability.

Another feature that increases the system's durability is the electronic board's dampening mounts that increase the system's durability to external impact.

With more than 30 years in the crane scales and dynamometers market, Ron Crane Scales is one of the leading brands in the global market with repeat customers like NASA, Boeing, GE, Siemens and many others.



Ron 2000 Shackle Type Dynamometer with Remote Indicator

Specifications

Safety Factor: Designed to 5:1

Proof Load: Each system proof-loaded to 200% of capacity (certified) up to a test force of 400t.

Accuracy: $\pm 0.1\%$ of full range.

Display: 5 digit, 1/2" (12mm) liquid crystal display with two overload warning levels, max. value (peak hold), low battery, tare state (gross or net), measuring unit, sleep state, charge and programming instructions. Standard number of measurements per second: 1. Standard display update rate per second: 1.

Sampling Rate: 200 per second.

Functions: Zero. Tare. Battery charge level. Low battery warning. Max. (peak hold). Two-level overload visual alarms. User calibration. Sleep mode after 60 sec. in zero value, awakes automatically when loaded.

Units: Available in the following measurement readings: metric tons, short tons (2000 lbs), kgs, lbs (lbs x 10 for capacities of 50t and above), newtons, deca newtons, k. newtons.

Load Cell Material: Made of high-strength, aerospace quality, alloy steel, polyurethane coated.

Indicator Material: High quality ABS.

Power: 3 x AA 1.5 Volt Alkaline disposable batteries, with battery life indication Batteries rated 3AH will function up to 2000 hours (three months of continuous working). Occasional use will extend the life of the batteries up to several years.

Adding certain options will shorten the life of the batteries. All settings retained at power off.

Calibration: User calibration. Initial factory calibration, fully traceable (certified).

Temperature Range:

Load cell: -15°F to $+175^{\circ}\text{F}$ (-25°C to $+80^{\circ}\text{C}$)

Indicator: -4°F to $+158^{\circ}\text{F}$ (-20°C to $+70^{\circ}\text{C}$).

Environmental: Weather proof NEMA4, IP 65



Ron 2000 Shackle Type Dynamometer with Remote Indicator

Options

- 1 or 2 user-adjustable set points
- Additional 0.5"/12mm LCD display with cable connection to indicator or wireless
- Additional 1"/25mm LCD display with cable connection to indicator or wireless
- Additional 2"/50mm LCD display with cable connection to indicator or wireless
- Additional 4"/100mm LED display with cable connection to indicator or wireless
- Additional extension cable in 15ft/5m increments
- Analog output: 0 to 1V / 0 to 2V / 0 to 3V
- Analog output: 4 to 20 mA
- Baud rate, user-selectable
- Carrying case: Pelican, High quality
- Dampened (average) display for unstable load
- Data logger - manual or automatic - up to 600 measurements
- Data logger - manual or automatic - up to 3,000 measurements
- Data logger - manual or automatic - up to 6,000 measurements
- Data logger - manual or automatic - up to 10,000 measurements
- Indicator belt clip
- IP 67 load cell with special off-shore connectors
- IP 68 load cell with underwater capability
- Longer extension cable in 15ft/5m increments
- Number of measurements per seconds: Up to 200 factory set
- Real-time clock
- Rechargeable batteries with an external charger
- Rope falls multiplier, user selectable
- RS-232 - continuous or on demand data output, user-selectable
- RS-485 - continuous or on demand data output, user-selectable
- Totalizer
- Units, user-selectable
- Wireless communication to additional display or PC
- USB



Ron 2000 Shackle Type Dynamometer with Remote Indicator

Dimensions Table and Drawing



Optional carrying case

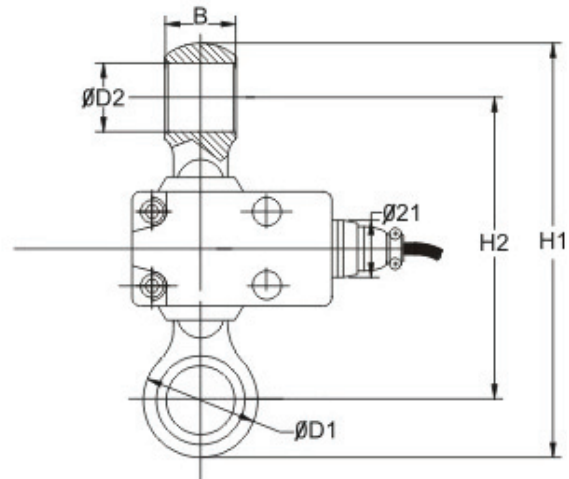

Cat no.	Full range		Resolution		Load cell weight		Cable length		H1 (max.)		H2 (max.)		B (max.)		ØD1 (max.)		ØD2 (min.)		Matching anchor shackle size*
	tons	kgs	lbs		kgs	lbs	mm	ft	mm	inch	mm	inch	mm	inch	mm	inch	mm	inch	inch
S-005	0.5	0.2	0.5		0.3	0.7	5	16	125	4.9	92	3.7	16	0.7	31	1.3	17	0.66	1/2 7/16 3/8
S-01	1	0.5	1		0.3	0.7	5	16	125	4.9	92	3.7	16	0.7	31	1.3	17	0.66	1/2 7/16 3/8
S-02	2	1	2		0.3	0.7	5	16	125	4.9	92	3.7	16	0.7	31	1.3	17	0.66	1/2 7/16 3/8
S-03	3	1	2		0.3	0.7	5	16	137	5.4	100	4	19	0.75	38	1.5	21	0.82	5/8 1/2
S-05	5	2	5		0.5	1	5	16	147	5.8	105	4.2	26	1	43	1.7	23	0.9	3/4 5/8
S-10	10	5	10		1.4	3.1	5	16	195	7.7	131	5.2	41	1.6	61	2.4	36	1.4	1 1/4, 1 1/8, 1
S-12	12.5	5	10		1.4	3.1	5	16	195	7.7	131	5.2	41	1.6	61	2.4	36	1.4	1 1/4, 1 1/8, 1
S-15	15	5	10		2.5	5.5	5	16	220	8.7	141	5.6	43	1.7	74	3	43	1.7	1 3/8
S-20	20	10	20		2.5	5.5	5	16	220	8.7	141	5.6	43	1.7	74	3	43	1.7	1 3/8
S-25	25	10	20		3.7	8	5	16	240	9.4	150	5.9	58	2.3	87	3.4	44	1.7	1 1/2
S-30	30	10	20		3.7	8	5	16	240	9.4	150	5.9	58	2.3	87	3.4	44	1.7	1 1/2
S-40	40	20	50		8	17	10	32	320	12.6	195	7.7	71	2.8	115	4.5	60	2.3	2, 1 3/4
S-50	50	20	50		8	17	10	32	320	12.6	195	7.7	71	2.8	115	4.5	60	2.3	2, 1 3/4
S-80	80	50	100		18	40	10	32	405	16.9	255	10	97	3.8	145	5.7	76	3	2 1/2
S-100	100	50	100		28	60	15	49	450	17.7	275	10.8	121	4.8	165	6.5	81	3.18	CROSBY No. 2160 125t
S-125	125	50	100		28	60	15	49	450	17.7	275	10.8	121	4.8	165	6.5	81	3.18	CROSBY No. 2160 125t
S-200	200	100	200		57	121	15	49	575	22.6	350	13.8	145	5.7	210	8.3	106	4.2	CROSBY No. 2160 200t
S-250	250	100	20		106	225	15	49	800	31.5	490	19.3	178	7.0	260	10.2	138	5.4	CROSBY No. 2140 250t or No. 2160 300t
S-300	300	100	200		106	225	15	49	800	31.5	490	19.3	178	7.0	260	10.2	138	5.4	CROSBY No. 2160 300t

* USE SHACKLES WITH S.W.L. (SAFE WORKING LOAD) EQUAL TO, OR GREATER THAN THE SYSTEM'S FULL RANGE.

* The company reserves the right to make changes without notice.